

Classifieds

Deadline For Classified Ads Is Noon, Friday Preceding Tuesday's Publication Date. \$5.00 minimum charge (prepaid) up to 25 words, \$6.00 if billed; 50¢ each additional 25 words.

To place your classified, stop by the LEWIS COUNTY HERALD or call 606-796-2331.

FOR RENT

Need an office in Frankfort? KPA is renting part of its building. Frankfort Office Space For Rent: Second floor with four large office areas. Office desks furnished. Located ½ mile from I-64 Lawrenceburg exit 53A. 10 minutes from the Capitol and Annex. Electric, water, gas, utilities and internet included. \$2,200 per month.

Call Bonnie Howard, Kentucky Press Association, 502-223-8821. 1tfn

VEHICLES

CASH for your unwanted car or truck. We can pick up. Call Stephen at 606-584-8881 or Mason County Auto Sales Buy/Here 606-883-3340, 4694 AA Highway, Dover, KY 41034. 27tfn

SERVICES

RICHARD WALJE
Sales Associate
STORY REALTY
"We Work For You"
606-262-0822 36tfn

Place your
classified today!
Call
606-796-2331.

Ohio Valley Propane

606-932-2185 4tfn

Subscribe Today to
THE LEWIS COUNTY HERALD
Send to
336 Lions Lane,
Vanceburg, KY 41179

MIKE'S BODY SHOP

Over 20 yrs. of experience
Free Estimates • Frame Alignment
All Insurance Claims Welcome
Clear Coat Paint System
AA Hwy. & Briery Rd., Quincy, KY
606-757-3325
Mike Clark, Owner
Add-On Car & Truck Accessories
After Market Replacement Parts
Now Accepting Credit Cards
24-HOUR TOWING



AFTER HOURS TOWING
606-757-9452 4tfn

H&H Continuous Guttering

5" and 6",
Vinyl
Siding,
Soffit and
Fascia Cover
Owner:
Wayne Hughes
606-796-3833
541-5256 25tfn

REDBUD REAL ESTATE

ROGER JAHN
PRINCIPAL BROKER

Vanceburg's oldest Real Estate firm, established 2005.

606-796-2660



Get texts of Lewis County breaking news, school closings and severe weather notices on your cellular phone.

Text "lewiscounty" to 78015.



THE LEWIS COUNTY HERALD

336 Lions Lane, Vanceburg, KY 41179

Classified Ads Sell



Benny J Miller
Ph: 1-660-953-1478
Vanceburg, KY

* 5" & 6"
Seamless Gutters
* Gutter Guards
* Metal roofing
* Free Estimates 24tfn

Find us on
Facebook

THE LEWIS COUNTY HERALD/Vanceburg Sun
recording Lewis County's history for more than 100 years.

REDBUD REAL ESTATE

LISA GRABINSKI

If you are considering selling, buying, someone to help manage your property, or simply want to chat about real estate, I am here to help.

606-202-3722



Dean Ginn & Son

Plumbing Contractors | Residential & Commercial

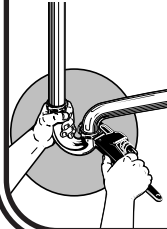

**Sewer & Drain Cleaning
Gas & Water Lines
Frozen Pipes**

Dean Ginn:
606-796-2153
606-796-3135 18tfn

TRI-STATE LAND COMPANY

Walton, KY • 859-485-1330

24 ¾ Ac. Sullivan Ridge Road, rolling pasture ground, old tobacco barn, city water. Land Contract available with \$4,000 down payment. \$124,900.

14 Ac. Sullivan Ridge Road, close to Mason County, open in front, falling off into woods, city water available, \$3,000 down and \$875 Per Mo.

Check our website for more properties.
www.tri-statelandcompany.com 25tfn

SUBSCRIBE TODAY!

AUTO | HOME | LIFE | BUSINESS | A MEMBER SERVICE | KYFB.COM

Small town service. Big time commitment.



No matter where you live in Kentucky, there's a Kentucky Farm Bureau Insurance agent nearby committed to taking care of your insurance needs.

Chris Elam, Agency Manager
60 Market St.
Vanceburg, KY
606-796-2132

Mon., Tues., Thurs. and Fri. 8 a.m.-5 p.m., Wed. 8 a.m.-Noon



BIG ON COMMITMENT. 19tfn

THE LEWIS COUNTY HERALD deadline for all submissions is Noon Friday.

Lewis County Schools AHERA Annual Notice

TO: Parents, Guardians, Teachers and School Employees

FROM: Timothy Underwood, LEA Designee

SUBJECT: Asbestos Management Plan for Lewis County Schools
2025-2026 Academic School Year
Date: July 1, 2025

This notice informs you that Lewis County Schools complies with the Asbestos Hazard Emergency Response Act (AHERA-EPA 40 CFR Part 763). AHERA requires school systems to inspect their buildings for asbestos containing building materials and to have a written asbestos management plan.

An Asbestos Management Plan for the school district is available for review at the Central Office during normal business hours. Please contact me if you would like to view this Plan. A copy of the Plan is also available at each school.

Mr. Timothy Underwood
Contact #: (606) 796-2811

Public Notice 31,32c



ADVANTAGEPLUSREALTY.NET

7221 US 60
Ashland KY 41102
606-928-0123

113 S 3rd St.
Ironton OH 45638
740-377-7955

Licensed in
KY, OH, WV & TN!



168 Main St.
Vanceburg KY 41179
606-796-9667

 Amy Stevens-Baker 606-923-5410	 Angie Krivchenia 606-922-2291	 Robert Grizzle 740-550-3438	 Josh Miller 606-923-9062	 Tabitha Smith 606-571-9059	 Brittany Wilson 606-465-7249	 Cindy Wright 606-571-8477
 Mary-Dawn Selby 606-831-2188	 Carole Wagner 304-360-3001	 Jessica Staten 606-369-5042	 Denise Proffitt 606-371-4600	 Shanna Unrue 606-831-5884	 Telisa Perkins 606-615-0265	 Tessa Bentley-Hall 304-730-1324
 James Stephens 606-822-1079	 Linda Conley 606-694-5474	 Paul Patterson 606-367-0593	 Jennifer Worthington 606-323-3882	 Mark Smith 606-571-6910	 Leland Wharton 469-929-3540	 Julie Reeves-Davis 304-208-7436
 Matt Horn 606-465-4628	 Liza Dixon 606-694-6486	 Djwara Colegrove 606-254-9948	 Heather Hensley 606-615-3749	 Donna Wharton 606-465-0328	 Kelli Horn 606-547-5404	 Kimberly Cook 740-861-1284
 Sherry Fannin 606-923-0508	 Courtney Hicks 606-939-3504	 Sherry Lynn 606-776-3215	 Samuel Lore 740-285-3972	 Ervena Howard-Kiser 606-922-1542	<p>"Honesty, Integrity, Results" ADVANTAGEPLUSREALTY.NET Call Advantage Plus Realty for all of your REAL ESTATE needs! 19tfn</p>	

POSTEDS

All Land Postings Are \$6.00 Per Calendar Year (January – December)

The properties listed below are posted against hunters with either dogs, guns or both; also trappers, trespassers, four wheelers and unauthorized timber cutters. Violators will be prosecuted.

Belita Adams, All Lands p226
Warren/Glenda O'Connell Adams, All Lands p226
Carolyn O. Applegate, All Lands
Ora Willis Applegate, All Lands
Laura Bachman & Dennis Howard, All Lands p226
Ralph & Dianna Bartles, All Lands
Beechy Hollow Farm LLC p226
Dale & Jennifer Bentley, All Lands p226
Kenny Bevins and Charlena Bevins, All Lands
Tamatha Bevins, All Lands
Bess Blaine & Ginger Kamers, All Lands p227
Gary S. Blaine, All Lands
Clyde & Garnetta Booker, All Lands
Joshua Booker, All Lands
James Boyd, All Lands
Elmo Bradley, All Lands
Bradner Farms, Inc. p226
Frank H. & Edith C. Brady, All Lands p226
John & Sharon Brindle, All Lands p227
Brown Communications, Inc., All Lands
Gordon & Dorothy Brown, All Lands
Tammy & Dennis Brown, All Lands

Barbara & William S. Bryant, Jr. All Lands
Buckler Farm, All Lands
Shirley Cagle, All Lands p231
Roger Caldwell, All Lands
Kenneth & Donna Carver, All Lands
Peggy Carver, All Lands p226
Shannon Carver, All Lands p226
Shelby Carver, All Lands
Chalk Ridge Farms LLC, All Lands
Eugene, Andria, & James Chatman, All Lands p226
Claude D. Clemons, All Lands p227
Corey Collins, All Lands
Rob Conway, All Lands
Anthony Corns Jr., All Lands
Anthony Sr. & Dianna Corns, All Lands
Dale Corns, All Lands
Joe Corns & Nicole Bradley, All Lands
Leonard & Rosetta Corns, All Lands
Bobby & Carolyn Cropper, All Lands
Donna A. Davis, All Lands
Dixon Farms, All Lands p226
Kevin Duff, All Lands
Esham Company, All Lands
Mitchell & Sandy Esham, All Lands p228
Jerry & Kathleen Fannin, All

Lands
Janet A. Farrow, All Lands
Earl & Rebecca Fisher, All Lands
Harlan L. Flinders Sr., All Lands
Peggy Flinders, All Lands
Gordon & Judy Geagley, All Lands p26
Michael & Marlene Geagley, All Lands p226
Aaron & Monika Gorelik, All Lands p226
Tim & Lora Hall, All Lands
Danny Hampton, All Lands p228
Danny & Paula Hampton, All Lands p228
Cheryl & Mark Hansen, All Lands p229
Jeanne Harris, All Lands
Heddleston & McGrew, All Lands
Robert & Carolyn Heddleston, All Lands p230
Robert & Ryan Heddleston, All Lands
Cory & Chad Hilterbrandt, All Lands
James R. & Marcia D. Hogue, All Lands p236
John Holsclaw, All Lands p226
Clinton & Lisa Hord, All Lands p226
John Hord & Robbie Hord, All Lands p227
Carolyn (David) Hughes, All

Lands
Tommy Hughes, All Lands p226
Buck Jordan, All Lands
John & Sandra Jordan, All Lands
Mark Jordan, All Lands
Jake & Bonnie Keen, All Lands p231
Stephen & Amanda Lester, All Lands
Dwight Lewis, All Lands
Gary & Opal Lewis, All Lands
Jeffrey Lewis, All Lands
Norma J. Lewis, All Lands
John Liles & Roxana Liles, Susan Liles, Edith Liles, All Lands p230
Ronald Lock, All Lands
Carlyle Logan, All Lands
Justin B. Logan, All Lands
Rhonda Mashburn, All Lands p226
Steven & Zachary Mashburn, All Lands p226
Steve McCann, All Lands
Dorothy McCleese, All Lands
Tim & Zachary McClurg, All Lands p227
Janet Tumlin McCormick, All Lands
McEldowney Farm LLC
Fred & Judy McGinnis, Pe-tersville, All Lands
Delbert & Carolyn McGlone, All Lands p233
Robie & Losa McGlone, All Lands

Johnny Mefford, All Lands
Arthur Brent & Elva Moore, All Lands p226
Wanda F. Morgan, All Lands
Tim Mullikin, All Lands
Ramona Myers & James Fannin, All Lands
Frank & Irene Nolen, All Lands
Gordon Nolen, All Lands
Lois J. Nolen, All Lands
Julie Pence, All Lands p226
People's Self-Help Housing, All Lands p226
Jeffrey Pilger, Cooper Hollow, All Lands
Silas & Aaron Polston, All Lands p226
Michael & Stacy Reed, All Lands p232
James H. and Lana K. Riffe, All Lands
Leoma Rigdon, All Lands
James Rister, All Lands
Mary Sue Roberts, All Lands 27
Roger & Geneva Rowe, All Lands p226
Charles & Gloria Rubacha, All Lands
William E. & Della & Mark Ruggles, Quincy, All Lands p227
Scaggs Farm, All Lands
Leo & Theresa Schlosser, All Lands
John Schnieders & Johnnae Rogers, All Lands

Shaw Farm, All Lands p226
Debra Slaughterbeck, All Lands p226
Devin and Judy Smith, All Lands p229
Elizabeth Smith, All Lands p226
Scotty Stamm, All Lands
Carlos Tackett, All Lands
Rob Tackett, All Lands
Wes Thomas, All Lands
Tinch Family, Happy Hollow Rd., All Lands
Anthony & Tyler Toller, All Lands p228
Samuel Tully, All Lands
Frank & Brenda Tumlin, All Lands
W.W. Turner, All Lands
Isaac & Haley Weddington, All Lands
Joseph Wesley & Michael Wesley, All Lands p227
April D. White, All Lands
Vicky Williams, All Lands
Joshua L. Wilson, All Lands
Tommy Bruce Wilson, All Lands
Tommy Bruce Wilson Jr., All Lands
Karen & Earnest Wolfe, All Lands p241
Larry & Heather Wright, All Lands

Do you have your land posted?