

Classifieds

Deadline For Classified Ads Is Noon, Friday Preceding Tuesday's Publication Date. \$5.00 minimum charge (prepaid) up to 25 words, \$6.00 if billed; 50¢ each additional 25 words.

To place your classified, stop by the LEWIS COUNTY HERALD or call 606-796-2331.

VEHICLES

CASH for your unwanted car or truck. We can pick up. Call Stephen at 606-584-8881 or Mason County Auto Sales Buy/Here 606-883-3340, 4694 AA Highway, Dover, KY 41034.

SERVICES

RICHARD WALJE
Sales Associate
STORY REALTY
"We Work For You"
606-262-0822

Place your classified today!

It pays to advertise in the classifieds! Call the Lewis County Herald 606-796-2331.

Ohio Valley Propane

606-932-2185

THE LEWIS COUNTY HERALD/Vanceburg Sun recording Lewis County's history for more than 100 years.

MIKE'S BODY SHOP

Over 20 yrs. of experience
Free Estimates • Frame Alignment
All Insurance Claims Welcome
Clear Coat Paint System
AA Hwy. & Briery Rd., Quincy, KY
606-757-3325
Mike Clark, Owner
Add-On Car & Truck Accessories
After Market Replacement Parts
Now Accepting Credit Cards
24-HOUR TOWING

AFTER HOURS TOWING
606-757-9452

H&H Continuous Guttering

5" and 6", Vinyl Siding, Soffit and Fascia Cover
Owner:
Wayne Hughes
606-796-3833
541-5256

Classified Ads Sell



REDBUD REAL ESTATE

AMY JO SKIDMORE

A text or call away to answer all of your Real Estate questions today.

606-541-4007



NOTICE OF PUBLIC HEARING

Notice is hereby given that the Kentucky Public Service Commission ("PSC") will conduct a public hearing in Case No. 2024-00115 beginning at 9:00 a.m. Eastern Standard Time on Thursday, December 19, 2024 in the Richard Raff Hearing Room (Hearing Room 1) at its offices at 211 Sower Boulevard, Frankfort, Kentucky 40601, for the purposes of cross-examination of the witnesses of Kentucky Power Company and taking evidence on the issues in PSC Case No. 2024-00115 regarding Kentucky Power Company's application to expand its existing demand-side management program (the Targeted Energy Efficiency Program) and approve two new demand-side management programs (the Home Energy Improvement Program and the Commercial Energy Solutions Program). This hearing will be streamed live and may be viewed on the PSC website at psc.ky.gov. Public comments may be made at the beginning of the hearing. Those wishing to make oral public comments may do so by following the instructions listing on the PSC website, psc.ky.gov.

REDBUD REAL ESTATE

ROGER JAHN
PRINCIPAL BROKER

Vanceburg's oldest Real Estate firm, established 2005.

606-796-2660



Dean Ginn & Son

Plumbing Contractors | Residential & Commercial

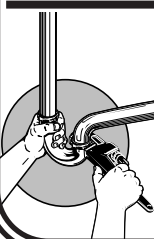

Sewer & Drain Cleaning
Gas & Water Lines
Frozen Pipes

Dean Ginn:
606-796-2153
606-796-3135

THE LEWIS COUNTY HERALD deadline for all submissions is Noon Friday.

Craig A. STANFIELD REAL ESTATE BROKER AUCTIONEER

Buy/Sell/ Lease/Auction

Let Craig or Ron make the Best Deal for you.

606-407-5045

ron.redden@gmail.com

www.stanfieldproperty.com



Ron Redden Agent

BJM SEAMLESS GUTTER

Benny J Miller
Ph: 1-660-953-1478
Vanceburg, KY

- * 5" & 6" Seamless Gutters
- * Gutter Guards
- * Metal roofing
- * Free Estimates

I am here to help!

REDBUD REAL ESTATE

LISA GRABINSKI

If you are considering selling, buying, someone to help manage your property, or simply want to chat about real estate, I am here to help.

606-202-3722



Get texts of Lewis County breaking news, school closings and severe weather notices on your cellular phone.

Text "Follow LCHerald" to 40404.

THE LEWIS COUNTY HERALD

187 Main St., Vanceburg, KY 41179

AUTO | HOME | LIFE | BUSINESS | A MEMBER SERVICE | KYFB.COM
Small town service. Big time commitment.



No matter where you live in Kentucky, there's a Kentucky Farm Bureau Insurance agent nearby committed to taking care of your insurance needs.

Chris Elam, Agency Manager
60 Market St.
Vanceburg, KY
606-796-2132

Mon., Tues., Thurs. and Fri. 8 a.m.-5 p.m., Wed. and Sat. 8 a.m.-Noon

KENTUCKY FARM BUREAU BIG ON COMMITMENT.

Important Information for Subscribers

Please notify us of your new address when you move so there will be no disruption in your newspaper delivery.

THE LEWIS COUNTY HERALD

187 Main Street,
Vanceburg, KY
41179

606-796-2331 •
800-572-2685

ADVANTAGE PLUS REALTY

ADVANTAGEPLUSREALTY.NET

7221 US 60
Ashland KY 41102
606-928-0123
113 S 3rd St.
Ironton OH 45638
740-377-7955

Licensed in KY, OH, WV & TN!
168 Main St.
Vanceburg KY 41179
606-796-9667

 Amy Stevens-Baker 606-923-5410	 Angie Kriwchenia 606-922-2291	 Robert Grizzle 740-550-3438	 Josh Miller 606-923-9062	 Tabitha Smith 606-571-9059	 Brittany Wilson 606-465-7249	 Cindy Wright 606-571-8477
 Mary-Dawn Selby 606-831-2188	 Carole Wagner 304-360-3001	 Jessica Stalen 606-369-5042	 Denise Proffitt 606-371-4600	 Shanna Unrue 606-831-5884	 Talisa Perkins 606-615-0265	 Tessa Bentley-Hall 304-730-1324
 James Stephens 606-232-1079	 Linda Conley 606-694-5474	 Paul Patterson 606-367-0593	 Jennifer Worthington 606-923-3882	 Mark Smith 606-571-6910	 Leland Wharton 469-929-3540	 Julie Reeves-Davis 304-208-7436
 Matt Horn 606-465-4628	 Liza Dixon 606-694-6486	 Djwana Colegrove 606-254-8948	 Heather Hensley 606-615-3749	 Donna Wharton 606-465-0328	 Kelli Horn 606-547-6404	 Kimberly Cook 740-861-1284
 Sherry Fannin 606-923-0508	 Courtney Hicks 606-939-3504	 Sherry Lyon 606-776-3215	 Samuel Lore 740-286-3972	 Ervena Howard-Kiser 606-922-1542	"Honesty, Integrity, Results" ADVANTAGEPLUSREALTY.NET Call Advantage Plus Realty for all of your REAL ESTATE needs!	

POSTEDS

All Land Postings Are \$6.00 Per Calendar Year (January - December)

The properties listed below are posted against hunters with either dogs, guns or both; also trappers, trespassers, four wheelers and unauthorized timber cutters. Violators will be prosecuted.

Belita Adams, All Lands Warren/Glenda O'Connell Adams, All Lands Carolyn O. Applegate, All Lands Ora Willis Applegate, All Lands William R. Austin, All Lands Laura Bachman & Dennis Howard, All Lands Ralph & Dianna Bartles, All Lands Michael & Dean Becker, Shaw Hollow, All Lands Dale & Jennifer Bentley, All Lands Kenny Bevins and Charlena Bevins, All Lands Bess Blaine & Ginger Kamer, All Lands Gary S. Blaine, All Lands Eric & Andrea Bloomfield, All Lands Norma L. Bloomfield, All Lands Clyde & Garnetta Booker, All Lands Joshua Booker, All Lands James Boyd, All Lands Bradner Farms, Inc., All Lands Frank H. & Edith C. Brady, All Lands Helen Brewer, All Lands Brown Communications, Inc., All Lands Gordon & Dorothy Brown, All Lands Tammy & Dennis Brown, All Lands Barbara & William S. Bryant,	Jr. All Lands Buckler Farm, All Lands Shirley Cagle, All Lands Roger Caldwell, All Lands Kenny & Donna Carver, All Lands Peggy Carver, All Lands William & Terri Caseman, All Lands Chalk Ridge Farms LLC, All Lands Eugene, Andria, & James Chatman, All Lands Claude D. Clemons, All Lands Corey Collins, All Lands Anthony Corns Jr. & Stephanie Corns, All Lands Anthony Sr. & Dianna Corns, All Lands Dale Corns, All Lands Joe Corns & Nicole Bradley, All Lands Leonard & Rosetta Corns, All Lands Bobby & Carolyn Cropper, All Lands Donna A. Davis, All Lands Kevin Duff, All Lands Lois & Bondi Dyer, All Lands Esham Company, All Lands Mitchell & Sandy Esham, All Lands Edward Evans, All Lands Jerry & Kathleen Fannin, All Lands Janet A. Farrow, All Lands Earl & Rebecca Fisher, All Lands Emily Flinders, All Lands Harlan Flinders Jr., All Lands	Harlan L. Flinders Sr., All Lands Peggy Flinders, All Lands John L. Gallenstein, All Lands Ronald & Wilma Gilliam, All Lands Donnie H. & Kathleen R. Ginn, All Lands William E. (Bill) and Morine Ginn, All Lands Aaron & Monika Gorelik, All Lands Tim & Lora Hall, All Lands Danny Hampton, All Lands Danny & Paula Hampton, All Lands Kenneth Howard Hamilton & Juanita Joyce Neu, All Lands Cheryl & Mark Hansen, All Lands Jeanne Harris, All Lands Robert & Carolyn Heddleston, All Lands Robert & Ryan Heddleston, All Lands Cheryl J. Henderson, All Lands Michael & Deborah Hershberger, All Lands Cory & Chad Hiltnerbrandt, All Lands James R. & Marcia D. Hogue, All Lands Clinton & Lisa Hord, All Lands John Hord & Robbie Hord, All Lands Tereatha Horsley, All Lands Gene & Bonnie Howell, All Lands Carolyn Hughes, All Lands	Tommy Hughes, All Lands Buck Jordan, All Lands John & Sandra Jordan, All Lands Mark Jordan, All Lands Jake & Bonnie Keen, All Lands Kegley Farm, All Lands Stephen Lester, Jr. & Amanda Lester, All Lands Dwight Lewis, All Lands Gary & Opal Lewis, All Lands Jeffrey Lewis, All Lands Norma J. Lewis, All Lands Edith Liles, All Lands Carlyle Logan, All Lands Justin B. Logan, All Lands Glenn Madden, All Lands Rhonda Mashburn, All Lands Steven & Zachary Mashburn, All Lands Steve McCann, All Lands Dorothy McLeese, All Lands Janet Tumlin McCormick, All Lands McEldowney Farm LLC Fred & Judy McGinnis, Petersburg, All Lands Delbert & Carolyn McGlone, All Lands Robbie & Lora McGlone, All Lands David Meadows, All Lands Johnny & Patricia Mefford, All Lands Arthur Brent & Elva Moore, All Lands Wanda F. Morgan, All Lands Tim Mullikin, All Lands Ramona Myers & James Fannin, All Lands	Gordon Nolen, All Lands Lois J. Nolen, All Lands Johnny & Donna Osborne, Micheal & Amy Hampton, All Lands People's Self-Help Housing, All Lands Kelli Phillips, All Lands Jeffrey Pilger, Cooper Hollow, All Lands Sharon Plummer and Suzanne Pick, All Lands Tom & Diana Plummer, All Lands Perry & Luwana Polley, Garden Branch, Little Cabin Creek, All Lands Silas & Aaron Polston, All Lands Michael & Stacy Reed, All Lands John & Clarissa Rentz, All Lands Bobby Riffe, All Lands, Lewis and Greenup Counties James H. and Lana K. Riffe, All Lands Billy and Leoma Rigdon, All Lands James Rister, All Lands Sue Roberts, All Lands Roger & Geneva Rowe, All Lands William E. & Della & Mark Ruggles, Quincy, All Lands Scaggs Farm, All Lands Leo & Theresa Schlosser, All Lands John Schnieders & Johnnae Rogers, All Lands	Larry Schumacher, All Lands Greenup Co. Mikel "Mike" Sebastian, All Lands Debra Slaughterbeck, All Lands Harold, Judy and Devin Smith, All Lands Scotty Stamm, All Lands Brenda & Dale Stamper, All Lands Paul & Connie Swearingen, All Lands Carlos Tackett, All Lands Rob Tackett, All Lands Tincher Family, Happy Hollow Rd., All Lands Anthony & Tyler Toller, All Lands Marvin Tully Sr., All Lands Samuel Tully, All Lands Frank & Brenda Tumlin, All Lands Isaac & Haley Weddington, All Lands Joseph Wesley & Michael Wesley, All Lands April D. White, All Lands Vicky Williams, All Lands Joshua Lee Wilson, All Lands Tommy Bruce Wilson, All Lands Tommy B. Wilson Jr., All Lands Karen & Earnest Wolfe, All Lands Larry & Heather Wright, All Lands Formerly Lon Zornes Farm, Old Trace Rd., All Lands
--	---	---	---	---	---